

GalvinSafe[®] Pedestal Floor Mtd, Axion[®] MSR Eye/Face Wash Head, S/Steel Bowl, Hand Act, (HAWS)

PRODUCT CODE:

Galvin Engineering: 190.82.11.12

HAWS: 7777-A



PRE - INSTALLATION

LOCATION OF UNIT: The Model 190.82.11.12 (7777-A) Stainless Steel combination Shower Eye/Face Wash should be installed in close proximity to potential accident areas. It should be clearly identified, free from obstructions and easy to access.

SUPPLY LINE: The minimum recommended line size is 1/2" BSP with 210 – 600 kPa flowing pressure. Where sediment or mineral content is a problem, an inlet filter is recommended.

PLUMBING CONNECTIONS: Inlet supply is female 1/2" BSPP. Waste outlet is male 1-1/4" BSPT.

INSTALLATION

Refer to installation drawing to clarify installation procedure.

PARTS BREAKDOWN

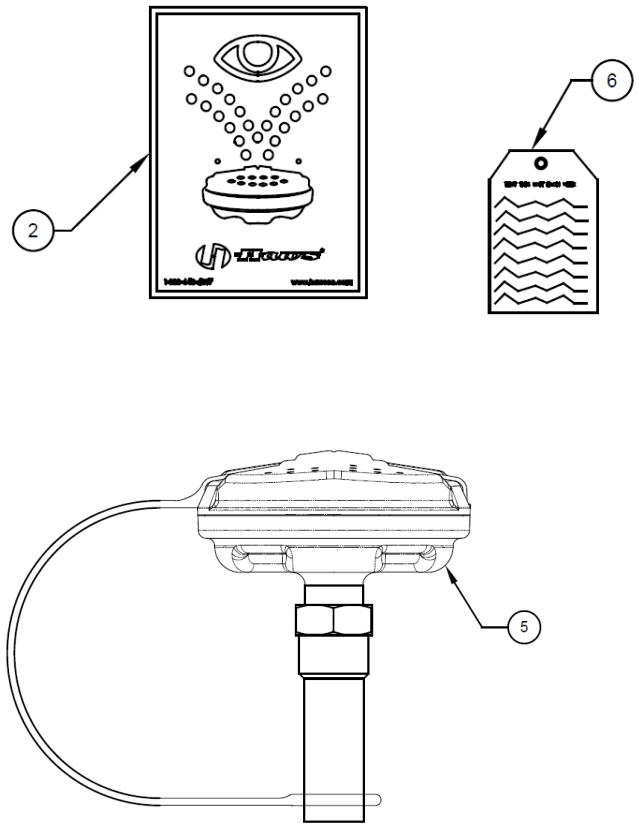
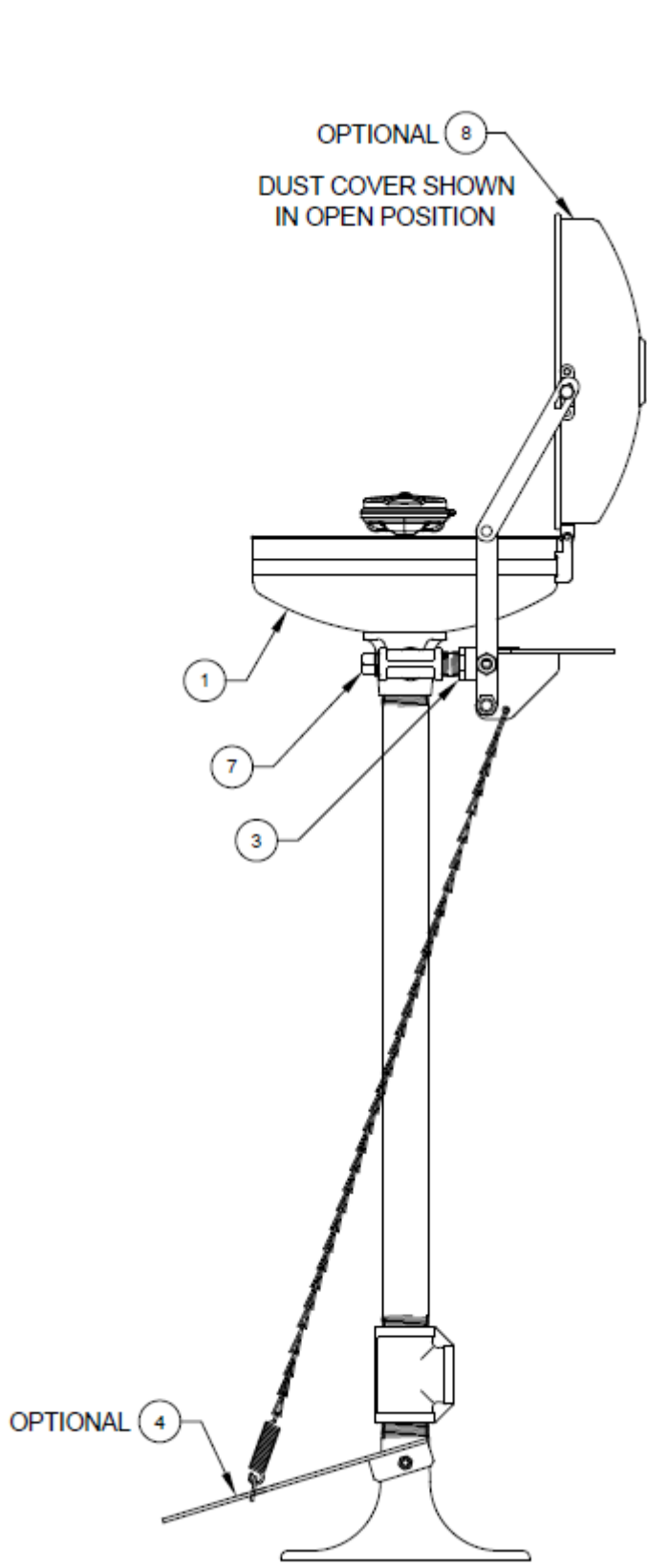

EYE/FACE WASH ASSEMBLY

ITEM	ITEM CODE	DESCRIPTION
1	190.92.22.20	BOWL
2	190.91.12.32	EMERGENCY EYE SAFETY SIGN
3	190.92.41.30	VALVE ASSEMBLY
4	190.91.22.12	FOOT TREADLE (OPTIONAL)
5	190.92.12.10	EYE/FACE WASH ASSEMBLY
6	190.91.80.33	TEST TAG
7	-	L-STRAINER*
8	-	SS DUST COVER ASSEMBLY* (OPTIONAL)

** spare parts will require special order or may not be available (contact Galvin engineering for more details).*

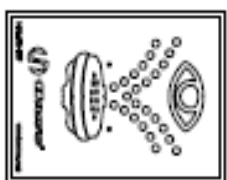

SIGN IS TO BE POSITIONED SUCH THAT IT IS VISIBLE WITHIN THE AREA SERVED BY THE EYE WASH

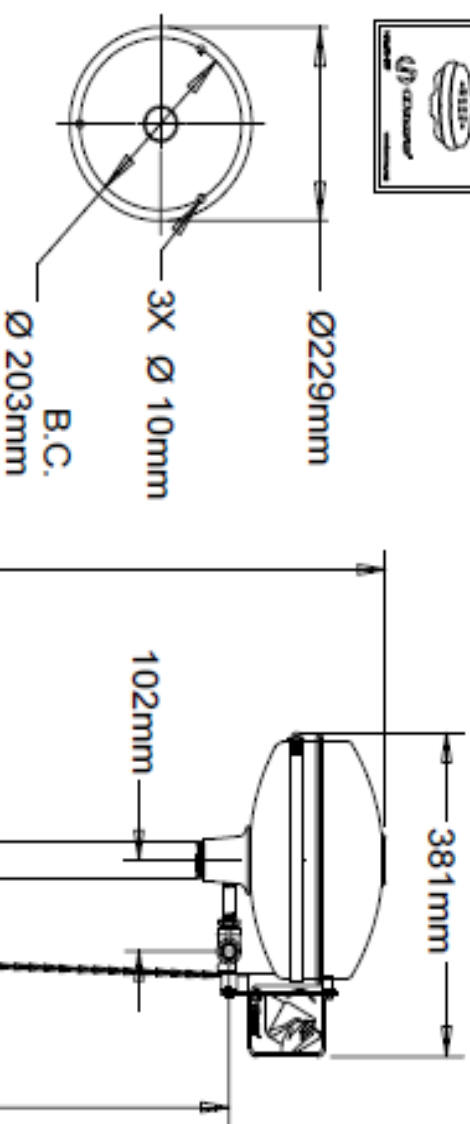

MOUNTING DETAIL

190.91.22.12
(FOOT TREDDLE
OPTIONAL)
FLOOR
LINE

NOTES:

1. WHEN INSTALLING THIS UNIT, LOCAL, STATE, OR FEDERAL CODES SHOULD BE ADHERED TO FOR INSTALLATION DIMENSIONS (LOCATIONS), WASTE AND SUPPLY REQUIREMENTS, OTHER THAN SHOWN.
2. TO COMPLY WITH AS 4775:
EYE WASH OR EYEFACE WASH SHALL BE POSITIONED SUCH THAT FLUSHING FLUID PATTERN IS NOT LESS THAN 888mm AND NO GREATER THAN 1346mm FROM SURFACE ON WHICH USER STANDS; AND 153mm MINIMUM FROM WALL OR NEAREST OBSTRUCTION.
3. CENTERLINE WASTE PLACED 229mm MIN FROM OBSTRUCTION.
4. O.M. APPLIES WHEN OPTIONAL 9102 DUST COVER ASSEMBLY IS USED.
REMOVE 13mm NPT PLUG TO GAIN ACCESS TO STRAINER FOR CLEANING. WHEN RE-ASSEMBLING STRAINER AND PLUG, MAKE SURE THAT STRAINER IS FULLY PRESSED INTO PLUG CAVITY, PRIOR TO THREADING PLUG INTO TEE.
6. * DIMENSIONS MAY VARY BY ±13 mm.

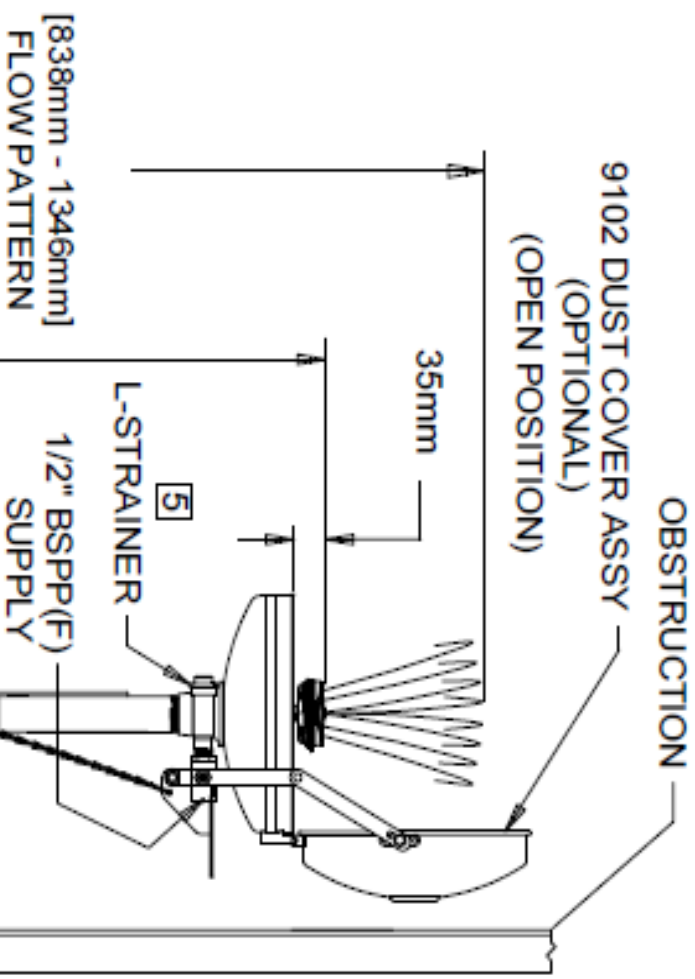

OBSTRUCTION
9102 DUST COVER ASSY
(OPTIONAL)
(OPEN POSITION)

* 171mm
WASTE



DISTRIBUTED BY:
GalvinEngineering
the mark of reliability

410 VICTORIANO MALAYA WA
ASB 70 000 719 312
461 8 8230 2344 FAX: 461 8 8230 2340
EMAIL: sales@galvinengineering.com.au
WEBSITE: www.galvinengineering.com.au

FIG NO	PROJ NO	REV	DATE	BY	CHKD	APP'D	SCALE	NO
1								
REVISED	DATE	BY	CHKD	APP'D	SCALE	NO		
MO DEL(S)		1 90 82 11 12 (7777 A)		GALVINSAFE PEDISTAL FLOORMNTD AXION MBR		EYEFACE WASH HEAD, SUSSTEL BOWL, HANDACT (HAWWS)		
PART NUMBER		001020080102D		REVISION		17		

TROUBLESHOOTING	
PROBLEM	REPAIR CHECKLIST
1. No Flow.	1. Check the main shut-off valve.
2. Insufficient water flow	2. a. Verify minimum 210 kPa flowing supply line pressure. b. Probable clogging of flow control due to inadequate line flushing. Unscrew eye/face wash head and remove the four screws to disassemble head. Clean flow control and reassemble Head. c. Remove plug located on L – Strainer using a 9/16” wrench to access clean filter screen.
3. Eye/face wash streams do not meet desired eye level.	3. Possible blocked flow control, see above solution. Possible non-leveled eye/face wash assembly
4. Water does not drain properly.	4. Check the main waste line of your building to see if it does handle the capacity required for the entire drainage system.

For more information about GalvinSafe[®] (Haws) products, see our website.

FLOW CONTROL CLEANING STEPS:

- 1 UNSCREW EYEFACE WASH ASSEMBLY FROM ADAPTER (NOT SHOWN).
- 2 REMOVE SCREWS (QTY. 4) FROM SP8S EYEFACE WASH ASSEMBLY. REMOVE EYEFACE WASH HEAD AND BUFFER (INSERT).
- 3 REMOVE EXISTING FLOW CONTROL FROM BASE BY PUSHING IT OUT FROM THE TOP AND CAREFULLY REMOVE ANY DEBRIS LODGED BETWEEN O-RING AND HOUSING OR OPENINGS. ALSO, CHECK FOR ANY SEDIMENT OR MINERAL DEPOSITS BLOCKING OPENINGS. EXERCISE CAUTION NOT TO DAMAGE OR LOSE O-RING IN THE PROCESS. ALL OPENINGS ON FLOW CONTROL MUST BE FREE AND CLEAR OF ANY OBSTRUCTIONS FOR FLOW CONTROL TO FUNCTION PROPERLY. REINSTALL FLOW CONTROL. SEE DETAIL A FOR ORIENTATION.
- 4 INSERT BUFFER (INSERT) INTO EYEFACE WASH HEAD NOTING ORIENTATION OF POST IN RELATIONSHIP TO ALIGNMENT GROOVE AS SHOWN ON DETAIL B.
- 5 REASSEMBLE EYEFACE WASH HEAD. MAKING SURE THAT ALIGNMENT GROOVE ON EYEFACE WASH HEAD LINES UP WITH ALIGNMENT TAB ON BASE.
- 6 REINSTALL SCREWS (QTY. 4) INTO THE EYEFACE WASH ASSEMBLY. TIGHTEN SNUG TO ENSURE A WATERTIGHT SEAL. DO NOT OVER-TIGHTEN. TORQUE SPEC: 4 IN. LBS. MAX
- 7 REASSEMBLE 190.92.12.10 EYEFACE WASH ASSEMBLY ONTO ADAPTER (NOT SHOWN). ORIENT TAB TOWARDS THE BACK (AWAY FROM USER). DO NOT OVER-TIGHTEN.
- 8 PLACE DUST COVER (NOT SHOWN) ONTO EYEFACE WASH.

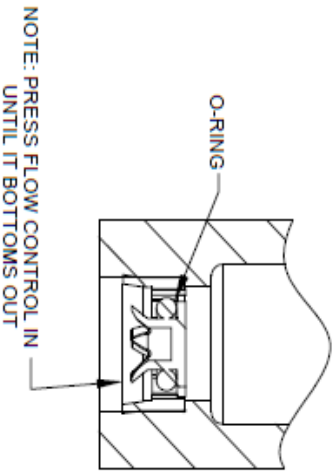
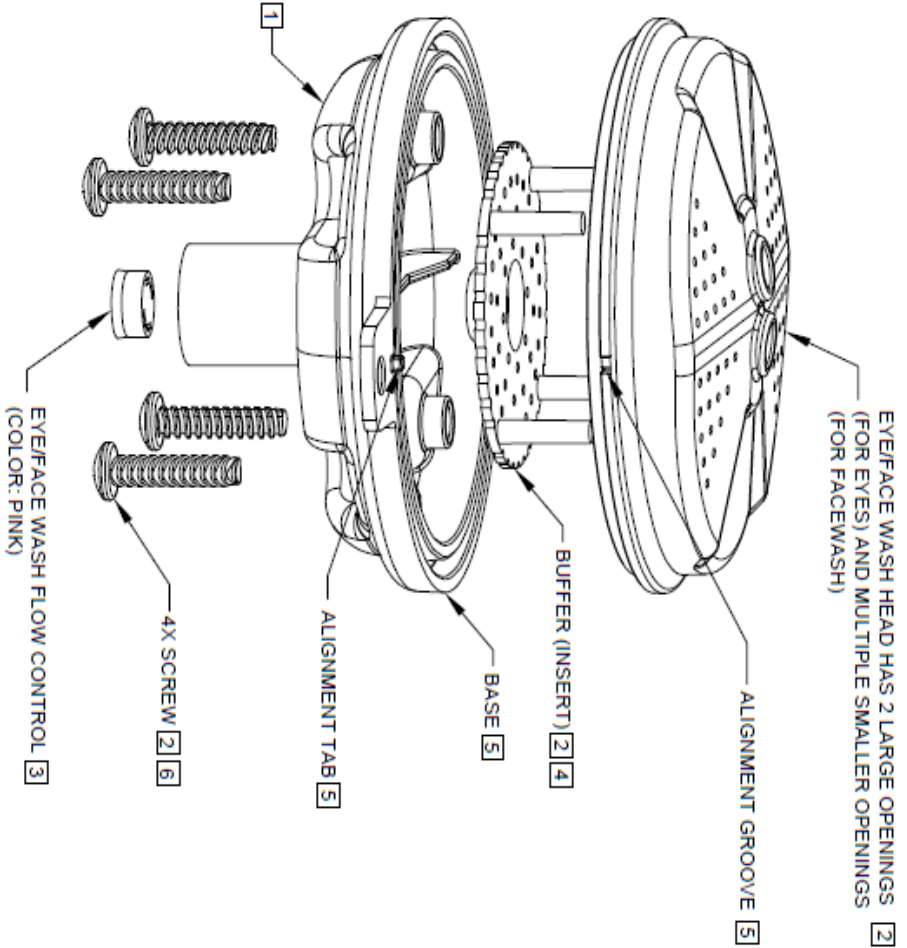

NOTE: PRESS FLOW CONTROL IN UNTIL IT BOTTOMS OUT

3 DETAIL A

FLOW CONTROL SHOWN IN PLACE

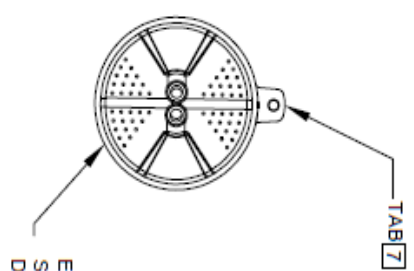

EYEFACE WASH SHOWN WITHOUT DUST COVER 8

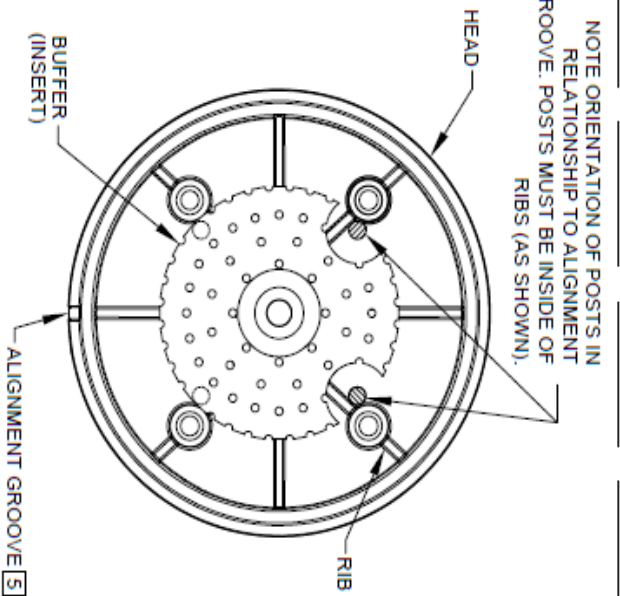

NOTE ORIENTATION OF POSTS IN RELATIONSHIP TO ALIGNMENT GROOVE. POSTS MUST BE INSIDE OF RIBS (AS SHOWN).

4 DETAIL B

SEE SHEET 1 OF 2 FOR INSTALLATION/RETROFIT STEPS

DISTRIBUTED BY:
GalvinEngineering
the mark of reliability

410 VICTORIA RD WILKINSON WA
 AUSTN 78 008 719 382
 +61 8 9338 2344 FAX: +61 8 9338 2340
 EMAIL: sales@galvinengineering.com.au
 WEBSITE: www.galvinengineering.com.au



EQN NO. / REVISIONS 4108 / DRAWN BY: / DATE: / CHECKED BY: / DATE: / APPROVED BY: / DATE:	MODEL(S) 190.92.12.10 (SP65) GALVINSAFE AXION MSR EYEFACE WASH HEAD (HAWS)	PART NUMBER 0002077031 DRAWING NO. / REV 15342A00 / 8
SCALE: 1:18 / DRAWING TYPE:	INSTALLATION:	SHEET: 2 OF 2

WARRANTY

The warranty set forth herein is given expressly and is the only warranty given by the Galvin Engineering Pty Ltd. With respect to the product, Galvin Engineering Pty Ltd makes no other warranties, express or implied. Galvin Engineering Pty. Ltd. hereby specifically disclaims all other warranties, express or implied, including but not limited to the implied warranties of merchantability and fitness for a particular purpose.

Galvin Engineering Pty Ltd products are covered under our manufacturer's warranty available for download from www.galvinengineering.com.au Galvin Engineering Pty Ltd expressly warrants that the product is free from operational defects in workmanship and materials for the warranty period as shown on the schedule in the manufacturer's warranty. During the warranty period, Galvin Engineering will replace or repair any defective products manufactured by Galvin Engineering without charge, so long as the terms of the Manufacturer's warranty are complied with.

The remedy described in the first paragraph of this warranty shall constitute the sole and exclusive remedy for breach of warranty, and Galvin Engineering Pty Ltd shall not be responsible for any incidental, special or consequential damages, including without limitation, lost profits or the cost of repairing or replacing other property which is damaged if this product does not work properly, other costs resulting from labour charges, delays, vandalism, negligence, fouling caused by foreign material, damage from adverse water conditions, chemical, electrical or any other circumstances over which Galvin Engineering has no control. This warranty shall be invalidated by any abuse, misuse, misapplication, improper installation or improper maintenance or alteration of the product.

Within Australia: 1300 514 074 Outside Australia: P: +61 (0)8 9338 2344

F: +61 (0)8 9338 2340

sales@galvinengineering.com.au

www.galvinengineering.com.au

ABN: 78 008 719 382

PERTH | SYDNEY | MELBOURNE | BRISBANE | ADELAIDE

